

NEW PREMISES LICENCE APPLICATION

GENERAL NOTES
 CONTRACTOR TO CHECK ALL DIMENSIONS ON THE SITE AND REPORT ANY DISCREPANCIES IMMEDIATELY.

FOUNDATION:-
 TO BE A MINIMUM OF 1.0 M. BELOW LOWEST GROUND LEVEL OR TO LEVEL ADJACENT DRAINS WHICHEVER IS DEEPER. TO BE EXCAVATED 0.6 M. BELOW ANY ROOTS FOUND IN TRENCH. USE 1:2.4 CONCRETE. (SULPHATE RESISTING CEMENT)
ABOVE GROUND DRAINAGE:- NEW SOIL AND VENT PIPES TO BS 5572. 100MM PVC PIPE TAKEN 1MTR. ABOVE ANY WINDOW WITHIN 3 METRES. AND FITTED WITH WIRE CAGE. NEW WASTES TO BE 38MM(SINK, BATH AND SHOWER) AND 32MM(BASIN) ALL FITTED WITH 75MM DEEP SEAL TRAPS. PROVIDED RODDING EYES OF CHANGE OF DIRECTION. COMMON WASTE PIPES TO BE MINIMUM 50MM IN DIAMETER.

FLASHINGS:-
 PROVIDE 150MM HIGH CODE 4 LEAD FLASHINGS TO ALL ABUTMENTS.

RAINWATER DISPOSAL:-
 PROVIDE 100MM PVC HALF ROUND GUTTERING WITH 63MM PVC DOWN PIPE DISCHARGING TO RODDABLE BACK INLET GULLIES AND CONNECTED TO EXISTING SURFACE WATER DRAINS. THE POSITION OF THE SURFACE WATER DRAINS IS TO BE LOCATED ON COMMENCEMENT OF WORK IF NOT READILY ASCERTAINABLE AND FINAL ARRANGEMENT TO BE AGREED WITH LA. SURVEYOR. OR ALTERNATIVELY TO MINIMUM 1CUBIC METRE SOAK AWAY MIN 5.0M FROM ANY BUILDING.

STEELWORK:-
 BEAMS TO BE ENCASED IN 2 LAYERS OF 12.5MM PLASTERBOARD WITH 1.6MM WIRE BINDING AT 100MM PITCH AND 5MM VERMICULITE GYPSUM PLASTER FINISH OR USE TWO COATS OF INTUMESCENT COAT TO MANUFACTURERS INSTRUCTIONS TO ACHIEVE HALF HOUR FIRE RESISTANCE.

SURFACE WATER:-
 125 DIAMETER HALF ROUND PVC GUTTERING WITH 65 DIAMETER RWP.S INTO 100DIA GULLY & 1 IN 40 PVC DRAIN ENCASED IN 150MM PEA SHINGLE TO NEW 3M3 SOAK AWAY AT LEAST 5M FROM FOUNDATIONS OR 6M IF IN CLAY SUB SOIL.

- FIRE EXTINGUISHER 6Lt. AFFF foam spray
- 9Lt. Water stored pressure
- 6Kg. (abc) Powder
- Emergency Light
- Heat Detector
- Smoke Detector
- CCTV camera
- Fire exist signage
- Licensable Activities

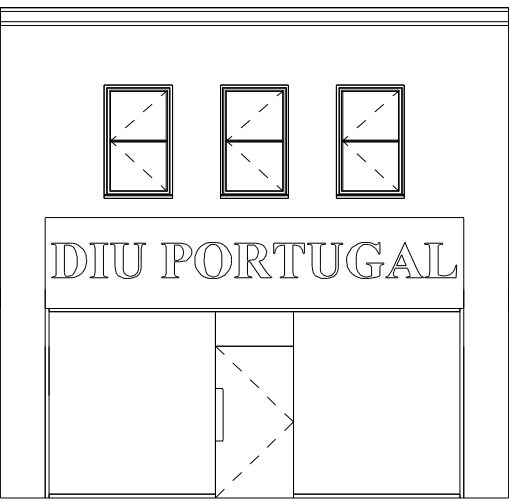

FRONT ELEVATION

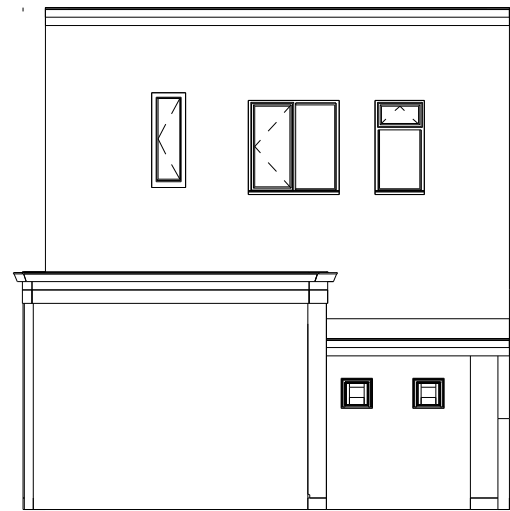

REAR ELEVATION

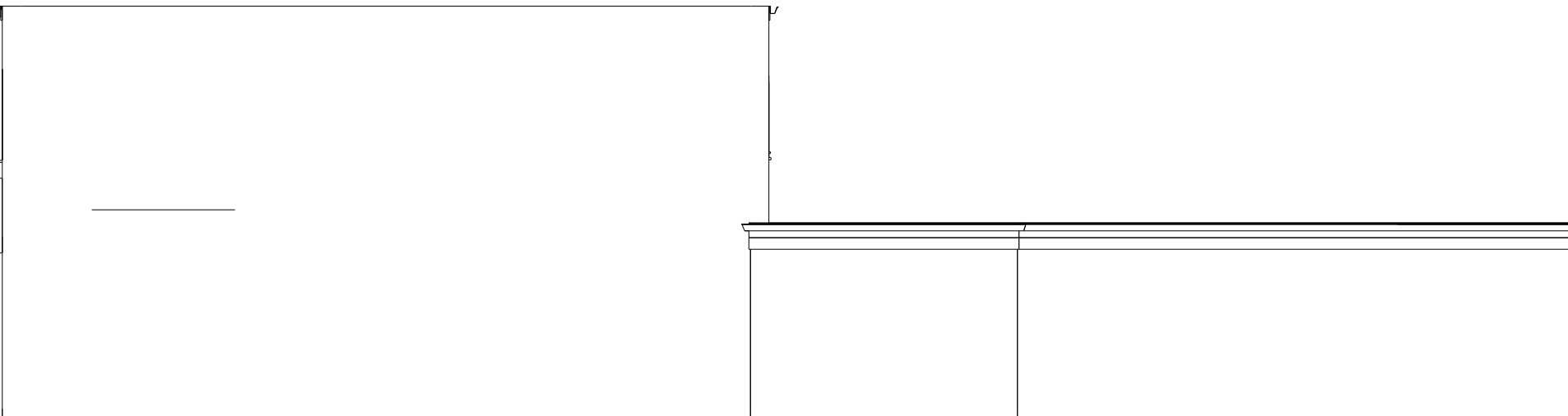

RIGHT SIDE ELEVATION

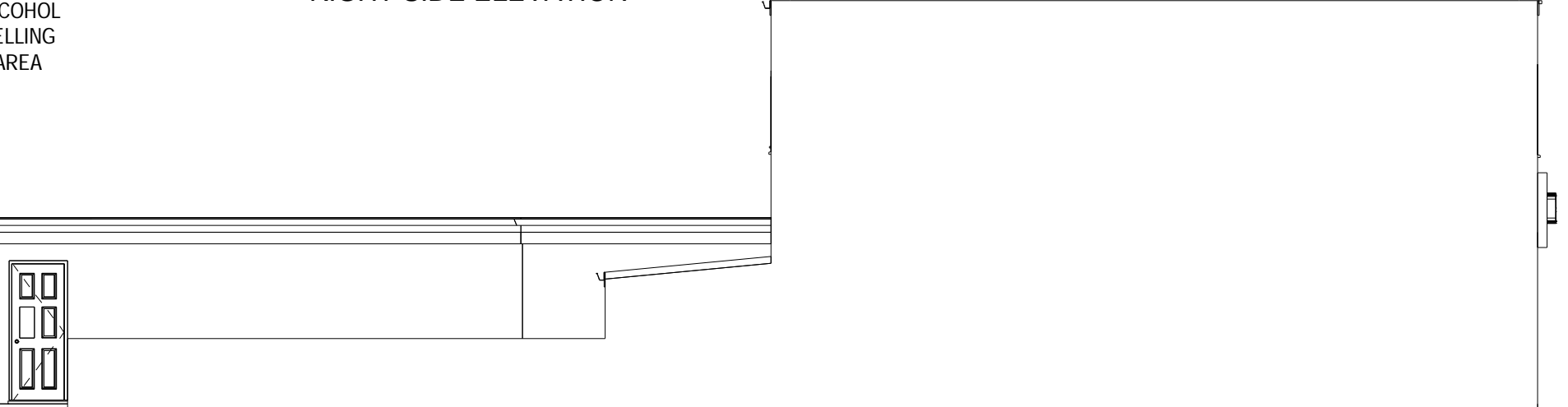

LEFT SIDE ELEVATION

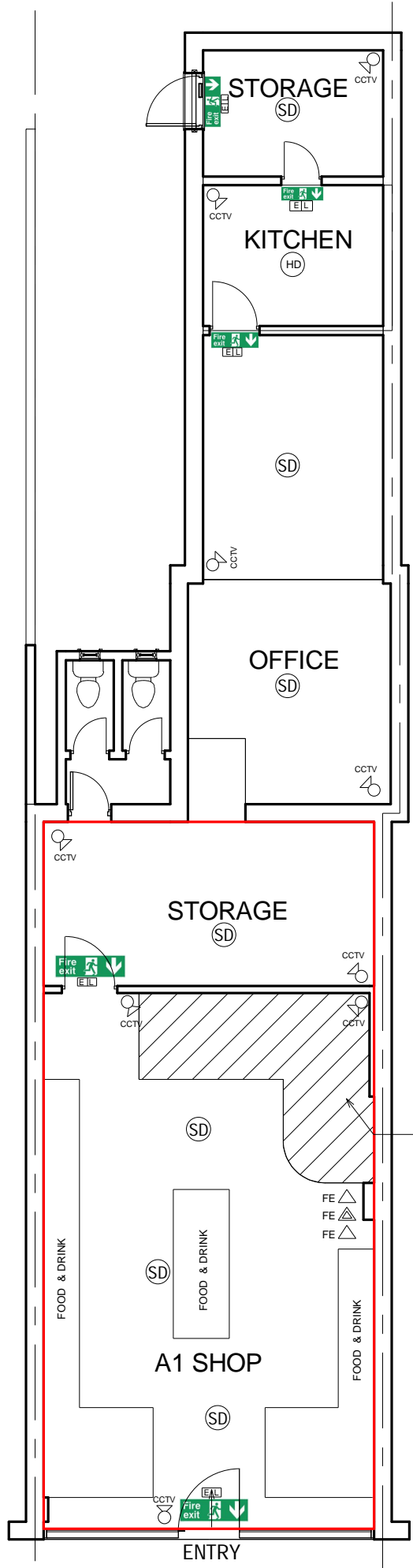

GROUND FLOOR PLAN



Rev No.	Date	Description
---------	------	-------------

Revision No.

DESIGN CRAFT
 Email: hemvarsani@hotmail.com

Cilent's Name
 Mr. Dipa Meggi Givane
 Address: 234 Ealing Road,
 Wembley.
 HAO 4QL

Drg. Title
PLANS & ELEVATION

Date 03/11/2017

Scale 1:100@A3

Drg. No. DG/BRENT/PLN/2017/A101